

biotrex



30L



50L



60L

SIMPLE LID ASSEMBLY

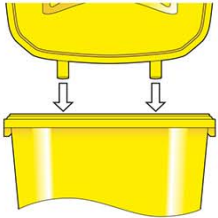

Insert the hinges of the lid into the slots of the container as shown

PRE-CLOSURE

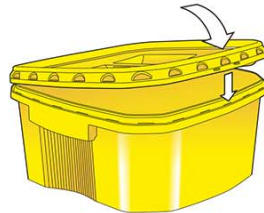

Lower the lid without forcing

FINAL CLOSURE

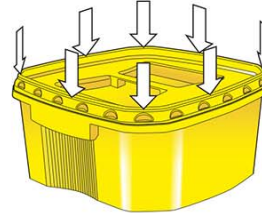

Push down consecutively all the sides of the lid to permanently close it

FILL LIMIT



PORTHOLE LID ASSEMBLY

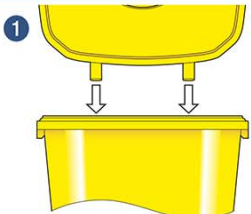

1 Insert the hinges of the lid into the slots of the container as shown

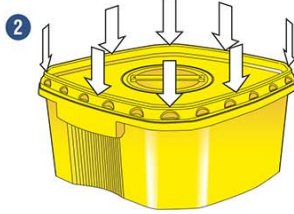

2 Push down consecutively all the sides of the lid to permanently close it

PRE-CLOSURE

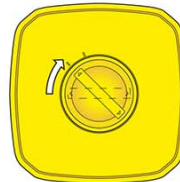

Insert the circular lid and turn it clockwise

OPENING

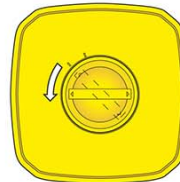

Turn the lid anticlockwise

FINAL CLOSURE

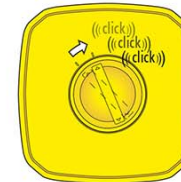

Turn the lid clockwise until you hear 3 clicks

TRANSPORT

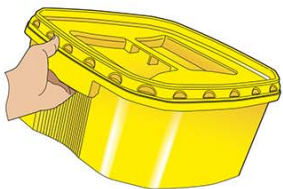

Side and top handles for transport

ACCESSORIES - TROLLEY



Insert the empty container with lid into the trolley. Attach the hook to the lid handle



Press the trolley pedal with foot to open the container

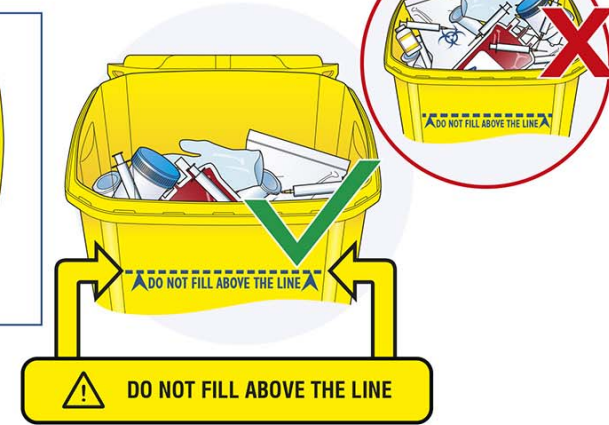

BIOLOGICAL RISK

CONFORMS WITH NORMS NFX 30-511 AND ISO23907: 2012
 AGREEMENT FOR THE TRANSPORTATION OF DANGEROUS MATERIAL
 ATTENTION: DO NOT FORCE THE INSERTION OF WASTE
 WASTE TO BE ELIMINATED ACCORDING TO REGULATIONS IN FORCE